

## Directions to White Horse Farm

### FROM THE A303, WINCANTON JUNCTION

(approx 16.5 miles from White Horse Farm)

Branch left A371 (*signposted Blandford*)  
(From London, this is the 2nd exit that is signposted for Wincanton). Then at roundabout take 1st exit. In 0.3 mile at roundabout, go forward.

#### **Junction with A357**

At roundabout take 1st exit A357 (*signposted Blandford*)

Junction with B3145 (Very windy road)  
Turn right B3145 (*signposted Sherborne*)  
Go via Charlton Horethorne towards Sherborne.

At Sherborne, turn right A30 (*signposted Yeovil*)

### FROM THE A30

Junction with A352  
(see above)

At traffic signals turn left  
[turn right from Yeovil] A352  
(*signposted Dorchester*)

In 0.7 mile turn right towards Longburton.  
Stay on this road. Middlemarsh is approx.  
6.5 miles later, White Horse Farm is situated  
off the A352, just after the Hunters Moon  
pub on the left hand side.

### FROM THE A35, (Coming from Lyme Regis)

Junction of A35 with A37  
(approx 10.5 miles from White Horse Farm)

As you approach Dorchester take the first exit off the roundabout (A37). At the next roundabout take the first exit (stay on the A37). Turn right at junction with A352 Charminster. Continue through Godmanstone. Continue through (edge of) - Cerne Abbas. Continue through Minterne Magna and Lyons Gate. Middlemarsh is approx. 1.5 miles later; White Horse Farm is situated just off the A352, just before the Hunters Moon pub on the right hand side.

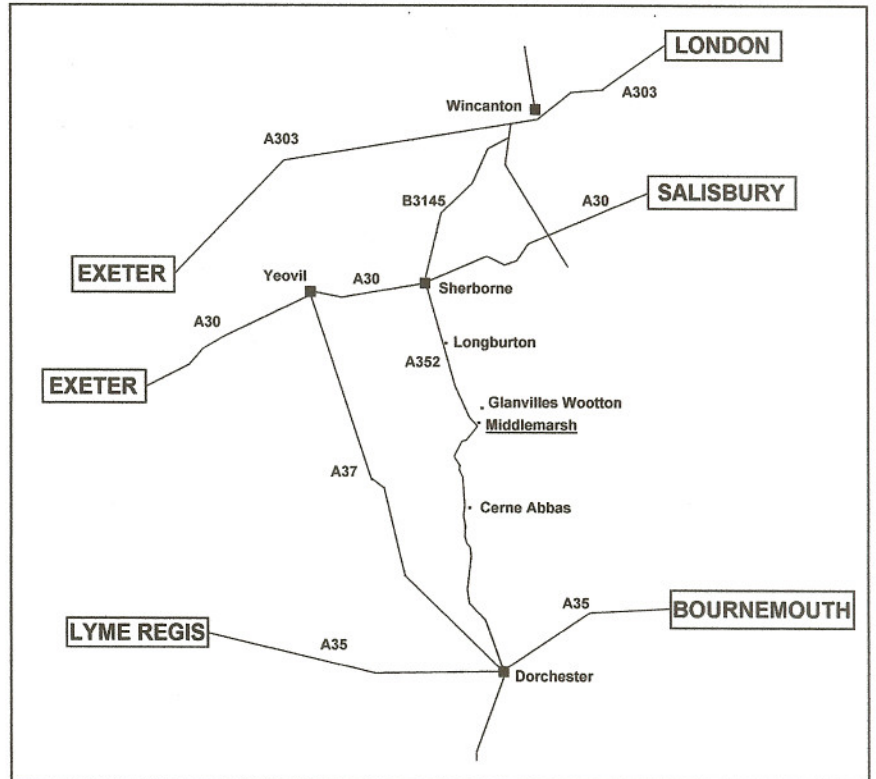

### FROM THE A35, (Coming from Bournemouth)

Junction of A35 with B3150

(approx 12 miles from White Horse Farm)

As you approach Dorchester take the 3rd exit off the roundabout into B3150/Stinsford Hill

Continue through high street until the roundabout. Take the 3rd exit (sign posted Yeovil & Sherborne). Turn right just before the BP petrol station. Stay on this road until you come into Middlemarsh. You will pass "The Old Sawmill" on the right hand side as you come into Middlemarsh. At the end of this road, turn right at the T-junction onto the A352 (sign posted Sherborne & Longburton). Shortly afterwards, White Horse Farm is situated off the A352 on the right hand side, just before the Hunters Moon

Please note that these directions are supplied as a guide only. You should always check the route you intend to use yourself.

**Please turn over for parking instructions** →

# Parking Instructions

## White Horse Farm

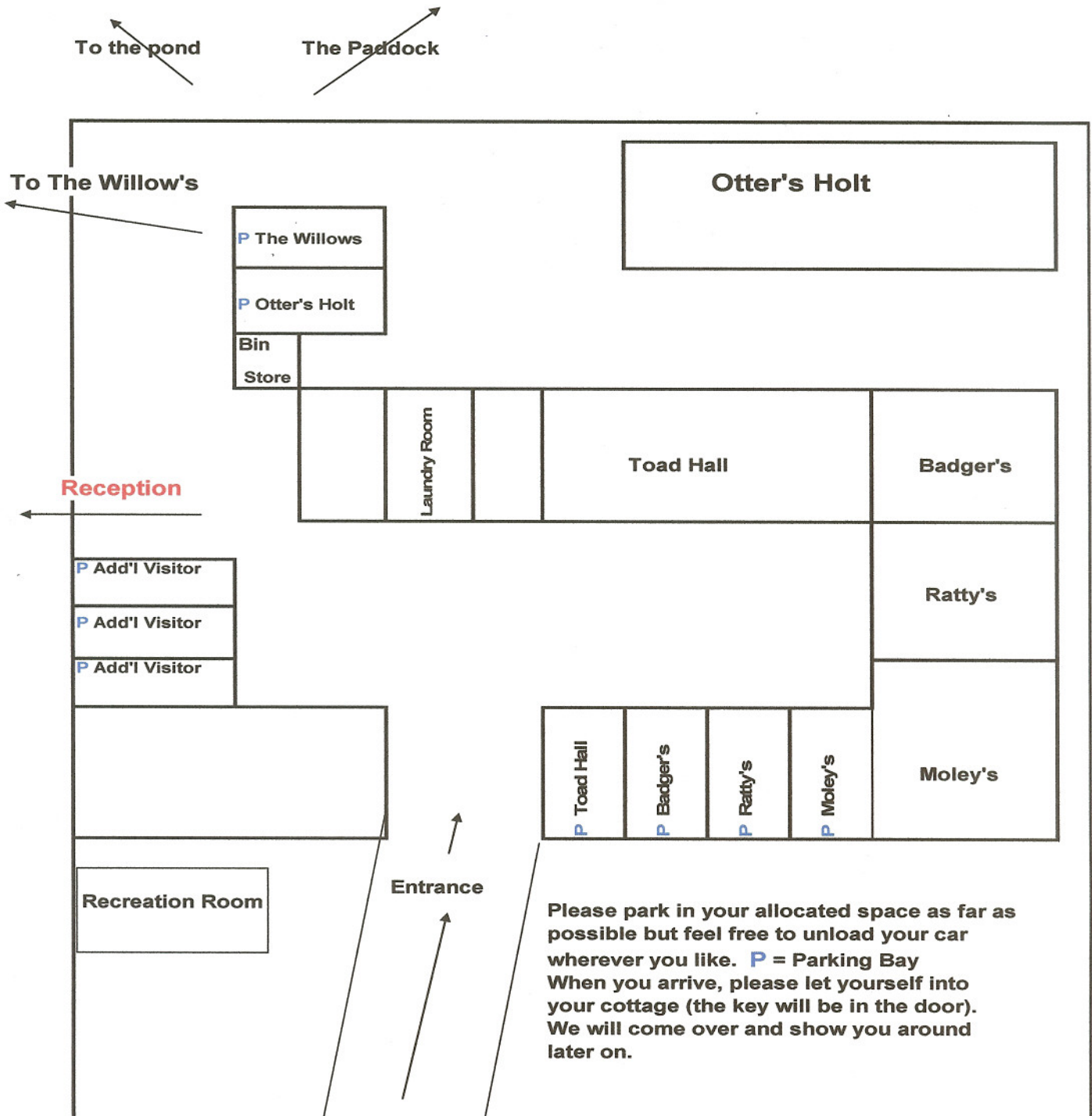

Please park in your allocated space as far as possible but feel free to unload your car wherever you like. **P** = Parking Bay  
When you arrive, please let yourself into your cottage (the key will be in the door). We will come over and show you around later on.

Please note that vehicles and their contents are driven and left in this car park at the owner's risk. We regret no liability can be accepted for loss or damage to the vehicle or injury to persons, however caused.

